



## *City of New Bedford* **REQUEST for a CERTIFIED ABUTTERS LIST**

This information is needed so that an official abutters list as required by MA General Law may be created and used in notifying abutters. You, as applicant, are responsible for picking up and paying for the certified abutters list from the assessor's office (city hall, room #109).

SUBJECT PROPERTY	
MAP #	LOT(S)#
ADDRESS:	
OWNER INFORMATION	
NAME:	
MAILING ADDRESS:	
APPLICANT/CONTACT PERSON INFORMATION	
NAME (IF DIFFERENT):	
MAILING ADDRESS (IF DIFFERENT):	
TELEPHONE #	
EMAIL ADDRESS:	
REASON FOR THIS REQUEST: <i>Check appropriate</i>	
<input type="checkbox"/>	ZONING BOARD OF APPEALS APPLICATION
<input type="checkbox"/>	PLANNING BOARD APPLICATION
<input type="checkbox"/>	CONSERVATION COMMISSION APPLICATION
<input type="checkbox"/>	LICENSING BOARD APPLICATION
<input type="checkbox"/>	OTHER ( <i>Please explain</i> ):

**Once obtained, the Certified List of Abutters must be attached to this Certification Letter.**

**Submit this form to the Planning Division Room 303 in City Hall, 133 William Street. You, as applicant, are responsible for picking up and paying for the certified abutters list from the assessor's office (city hall, room #109).**

### Official Use Only:

As Administrative Assistant to the City of New Bedford's Board of Assessors, I do hereby certify that the names and addresses as identified on the attached "abutters list" are duly recorded and appear on the most recent tax.

**Michael J. Motta**

Printed Name

Signature

Date

February 23, 2021

Dear Applicant,

Please find below the List of Abutters within 300 feet of the property known as 581 Hathaway Road (Map: 121, Lot: 86,37). The current ownership listed herein must be checked and verified by the City of New Bedford Assessor's Office. Following said verification, the list shall be considered a Certified List of Abutters.

Please note that multiple listed properties with identical owner name and mailing address shall be considered duplicates and shall require only 1 mailing. Additionally, City of New Bedford-Owned properties shall not require mailed notice.

<u>Parcel</u>	<u>Location</u>	<u>Owner and Mailing Address</u>
122-33	NO OF F R R R	CITY OF NEW BEDFORD, 133 WILLIAM STREET NEW BEDFORD, MA 02740
121-6	SWAMP S OF F R R R	CITY OF NEW BEDFORD, ADDITION TO GOLF COURSE 131 WILLIAM ST NEW BEDFORD, MA 02740
94-6	458 HATHAWAY RD	CITY OF NEW BEDFORD, SULLIVAN GRAN & CONST CO 131 WILLIAM ST NEW BEDFORD, MA 02740
94-49	596 HATHAWAY RD	HOCKERT-LOTZ NELSON F, PO BOX 790 MATTAPOISETT, MA 02739
121-7	SWAMP S OF F R R R	CITY OF NEW BEDFORD, ADDITION TO GOLF COURSE 131 WILLIAM ST NEW BEDFORD, MA 02740
94-20	366 HATHAWAY RD	BELINKOFF CYNTHIA A "TRUSTEE", 366 HATHAWAY REALTY TRUST (THE) P O BOX 70036 NO DARTMOUTH, MA 02747
94-23	372 HATHAWAY RD	191 III CUBE NEW BEDFORD SUB LLC, PTA - CS# 6832 P O BOX 320099 ALEXANDRIA, VA 22320
94-47	382 HATHAWAY RD	HATHAWAY HOLDINGS LLC, 275 MARTINE STREET - SUITE 110 FALL RIVER, MA 02723
94-56	HATHAWAY RD	COMMONWEALTH OF MASS 131 WILLIAM ST NEW BEDFORD, MA 02740
121-2	SOUTH OF F R R	CITY OF NEW BEDFORD, ADDITION TO GOLF COURSE 131 WILLIAM ST NEW BEDFORD, MA 02740
121-3	SWAMP S OF F R R R	CITY OF NEW BEDFORD, ADDITION TO GOLF COURSE 131 WILLIAM ST NEW BEDFORD, MA 02740
121-5	SWAMP S OF F R R R	CITY OF NEW BEDFORD, ADDITION TO GOLF COURSE 131 WILLIAM ST NEW BEDFORD, MA 02740
121-45	SOUTH OF F R R	CITY OF NEW BEDFORD, ADDITION TO GOLF COURSE 131 WILLIAM ST NEW BEDFORD, MA 02740

February 23, 2021

Dear Applicant,

Please find below the List of Abutters within 300 feet of the property known as 581 Hathaway Road (Map: 121, Lot: 86,37). The current ownership listed herein must be checked and verified by the City of New Bedford Assessor's Office. Following said verification, the list shall be considered a Certified List of Abutters.

Please note that multiple listed properties with identical owner name and mailing address shall be considered duplicates and shall require only 1 mailing. Additionally, City of New Bedford-Owned properties shall not require mailed notice.

<u>Parcel</u>	<u>Location</u>	<u>Owner and Mailing Address</u>
121-1	SOUTH OF F R R	CITY OF NEW BEDFORD, ADDITION TO GOLF COURSE 131 WILLIAM ST NEW BEDFORD, MA 02740
122-32	NO OF F R R R	CITY OF NEW BEDFORD, CONSERVATION 131 WILLIAM ST NEW BEDFORD, MA 02740
121-4	SWAMP S OF F R R R	CITY OF NEW BEDFORD, CONSERVATION 131 WILLIAM ST NEW BEDFORD, MA 02740
121-86	HATHAWAY RD	WHALING CITY GOLF CLUB INC, C/O CITY OF NEW BEDFORD 133 WILLIAM STREET NEW BEDFORD, MA 02740
121-60	1069 SHAWMUT AVE	SHAWMUT ASSOCIATES LLC, 1245 SHAWMUT AVENUE NEW BEDFORD, MA 02745
121-37	609 HATHAWAY RD	CITY OF NEW BEDFORD, WATER DEPT 131 WILLIAM ST NEW BEDFORD, MA 02740
121-96	ROUTE 140	SHAWMUT ASSOCIATES LLC, 1245 SHAWMUT AVENUE NEW BEDFORD, MA 02745
121-42	RIGHT OF WAY	PENN CENTRAL CO, CONSOLIDATED RAIL CORP 500 WATER STREET DEPT J910 JACKSONVILLE, FL 32202
122-35	NO OF F R R R	CITY OF NEW BEDFORD, 133 WILLIAM STREET NEW BEDFORD, MA 02740
122-36	NO OF F R R R	CITY OF NEW BEDFORD, 133 WILLIAM STREET NEW BEDFORD, MA 02740
123-72	SHAWMUT AVE	NATIONAL PROPANE,LIMITED PARTNERSHIP, C/O AMERIGAS EAGLE PROPANE, L.P. P O BOX 798 VALLEY FORGE, PA 19482-9908
123-30	1099 SHAWMUT AVE	NATIONAL PROPANE,LIMITED PARTNERSHIP, C/O AMERIGAS EAGLE PROPANE, L.P. P O BOX 798 VALLEY FORGE, PA 19482-9908
122-38	NO OF F R R R	CITY OF NEW BEDFORD, 133 WILLIAM STREET NEW BEDFORD, MA 02740

February 23, 2021

Dear Applicant,

Please find below the List of Abutters within 300 feet of the property known as 581 Hathaway Road (Map: 121, Lot: 86,37). The current ownership listed herein must be checked and verified by the City of New Bedford Assessor's Office. Following said verification, the list shall be considered a Certified List of Abutters.

Please note that multiple listed properties with identical owner name and mailing address shall be considered duplicates and shall require only 1 mailing. Additionally, City of New Bedford-Owned properties shall not require mailed notice.

<u>Parcel</u>	<u>Location</u>	<u>Owner and Mailing Address</u>
122-63	NO OF F R R R	CITY OF NEW BEDFORD, CONSERVATION 131 WILLIAM ST NEW BEDFORD, MA 02740
123-90	SHAWMUT AVE	CITY OF NEW BEDFORD, WATER DEPT 131 WILLIAM ST NEW BEDFORD, MA 02740
123-24	1103 SHAWMUT AVE	CITY OF NEW BEDFORD, BOARD OF HEALTH 131 WILLIAM ST NEW BEDFORD, MA 02740
122-3	SHAWMUT AVE	CITY OF NEW BEDFORD, AIRPORT COMMISSION 131 WILLIAM ST NEW BEDFORD, MA 02740
94-36	360 HATHAWAY RD	R & E REALTY LIMITED PARTNERSHIP, 8 PROSPECT ROAD MATTAPOISETT, MA 02739
94-1	580 HATHAWAY RD	KING DANIEL P, KING MARIA LUCIA 580 HATHAWAY RD NEW BEDFORD, MA 02740
94-2	500 HATHAWAY RD	EMERALD PARTNERSHIP LTD, 500 HATHAWAY ROAD NEW BEDFORD, MA 02740

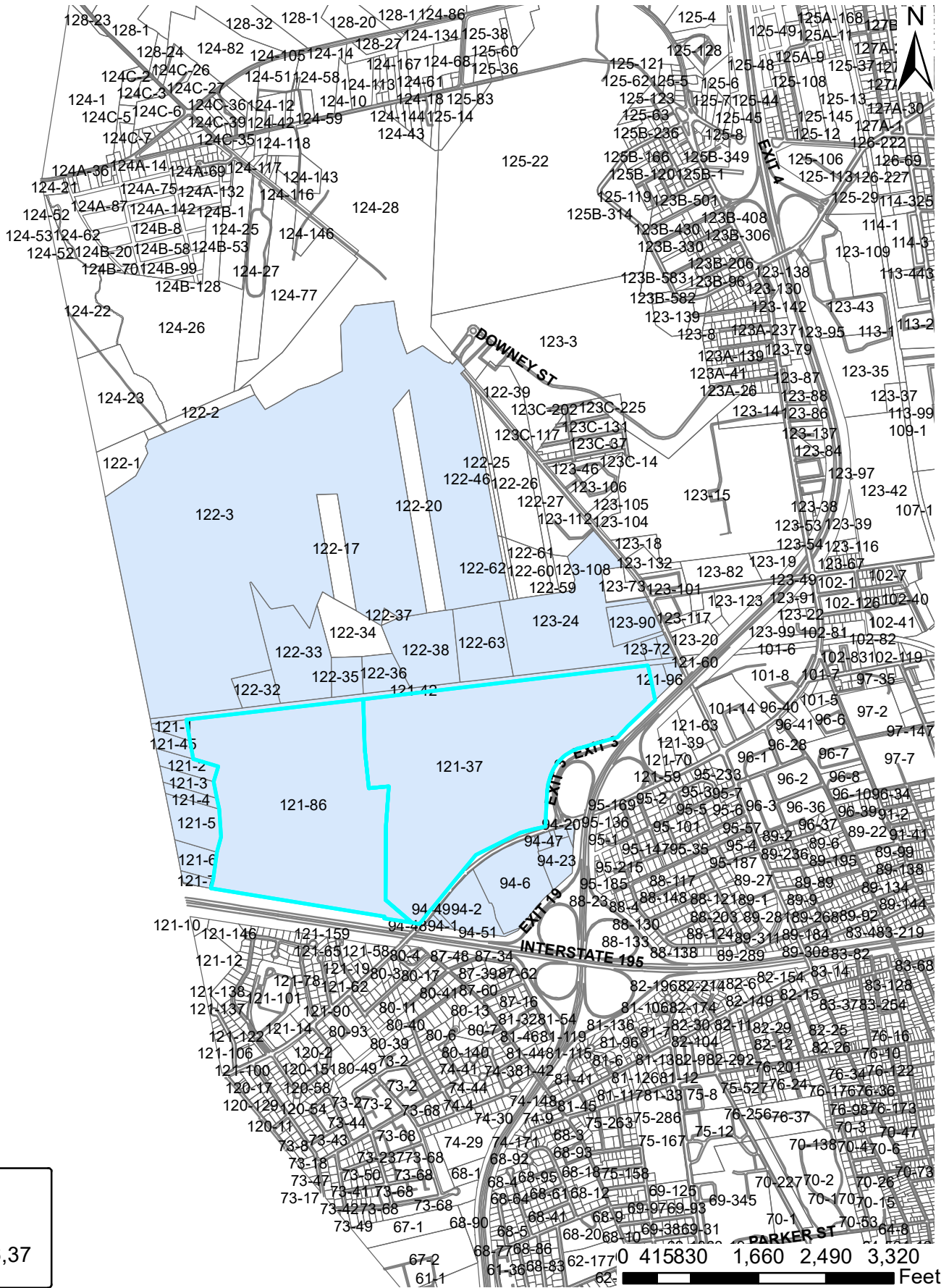

**Legend**

121-86,37

City of New Bedford, Massachusetts  
Department of City Planning

Parcel within 300FT

